

## 2.5 Tube Cap

### 01. Fractional Tube

Material - **SS 304 | SS 316**

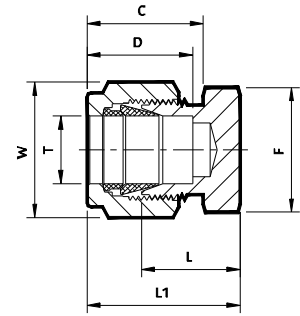
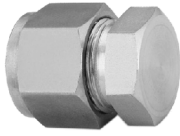

Sr. No.	TUBE OD Ø T	Ref. Part No.		D	C	L	L1	Body Hex F	Nut Hex W
		SS 304	SS 316						
		TCD4	TCD6	Dimensions in Inches					
1	1/8	2TCDx4	2TCDx6	0.50	0.60	0.53	0.79	7/16	7/16
2	1/4	4TCDx4	4TCDx6	0.60	0.70	0.63	0.92	9/16	9/16
3	5/16	5TCDx4	5TCDx6	0.64	0.73	0.67	0.96	5/8	5/8
4	3/8	6TCDx4	6TCDx6	0.66	0.76	0.72	1.01	11/16	11/16
5	1/2	8TCDx4	8TCDx6	0.90	0.86	0.75	1.15	7/8	7/8
6	5/8	10TCDx4	10TCDx6	0.96	0.86	0.78	1.18	1	1
7	3/4	12TCDx4	12TCDx6	0.96	0.86	0.84	1.24	1.1/16	1.1/8
8	1	16TCDx4	16TCDx6	1.23	1.04	1.03	1.51	1.3/8	1.1/2

### 02. Metric Tube

Material - **SS 304 | SS 316**

Sr. No.	TUBE OD Ø T	Ref. Part No.		D	C	L	L1	Body Hex F	Nut Hex W
		SS 304	SS 316						
		MTCd4	MTCd6	Dimensions in Millimetres					
1	3	3MTCd4	3MTCd6	12.9	15.3	13.5	20.1	11.1	11.1
2	6	6MTCd4	6MTCd6	15.3	17.7	15.7	23.1	14.2	14.2
3	8	8MTCd4	8MTCd6	16.2	18.6	17.0	24.5	16	16
4	10	10MTCd4	10MTCd6	17.2	19.5	19.0	26.6	19	19
5	12	12MTCd4	12MTCd6	22.8	22.0	19.0	29.1	22.2	22.2
6	14	14MTCd4	14MTCd6	24.4	22.0	19.8	29.9	25.4	25.4
7	15	15MTCd4	15MTCd6	24.4	22.0	19.8	29.9	25.4	25.4
8	16	16MTCd4	16MTCd6	24.4	22.0	19.8	29.9	25.4	25.4
9	18	18MTCd4	18MTCd6	24.4	22.0	21.3	31.4	27	30
10	20	20MTCd4	20MTCd6	26.0	22.0	23.9	34.0	30	32
11	25	25MTCd4	25MTCd6	31.3	26.5	26.2	38.5	35	38

NOTE : ① Dimension L1, C, D is shown in the finger-tight position.